

# LEVEL 1 FOYER





## ABOUT THE FOYER

Our bright and spacious foyers offer a unique range of additional spaces, ranging from 300m<sup>2</sup> to 1000m<sup>2</sup>.

Offering delegates a breath of fresh air between conference and meeting sessions, where panoramic views of Dublin city and surrounding Wicklow mountains can be admired, our light-flooded foyers are also perfect for registration, welcome receptions and hospitality.

Level 1 foyer also has full bar facilities, hidden behind our iconic feature wall.

## Key

-  Power Access
-  Integrated Bar
-  Pillar
-  Mobile Signage Unit
-  Window

## FOYER PLAN



## FOYER VIEW

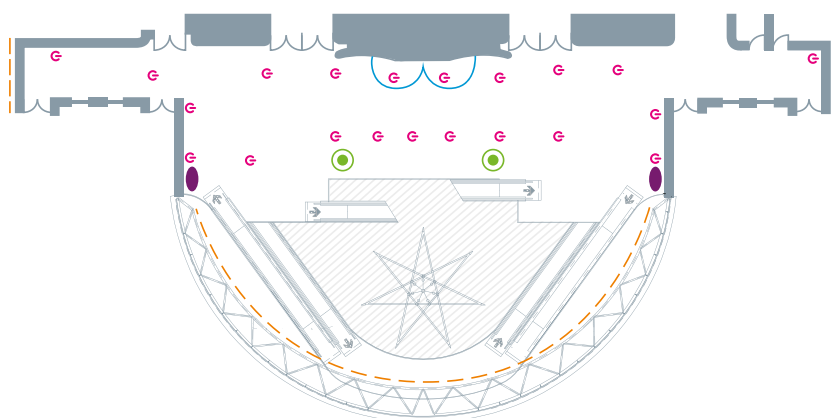

## FLOOR PLAN - LEVEL 1

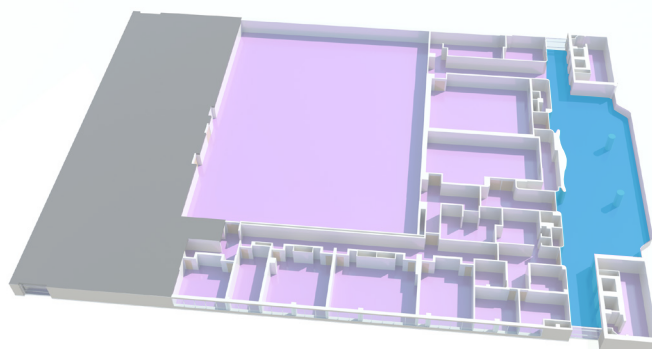

### PLEASE NOTE

You may need additional Wi-Fi and power depending on your event's requirements. Your Event or Technical Production Manager will be happy to provide you with recommendations and quotes. This floor plan is to be used as a guide only, please contact your Event or Technical Production Manager for more detailed information and plans.