

INSPIRING EVENTS



# WELCOME TO IRELAND'S NEW WORLD-CLASS CONVENTION CENTRE

## A UNIQUE EXPERIENCE IN THE HEART OF DUBLIN

Prepare to experience a conference location like no other, right in the heart of Dublin – perhaps Europe's most vibrant capital. Positioned in the exciting Spencer Dock area on the banks of the River Liffey, The Convention Centre Dublin is Ireland's new world-class, purpose-built international conference and event venue.

Providing an exceptional venue and backdrop for some of the world's leading international association conferences and corporate events, the centre's iconic status combines spacious, flexible and elegant conference halls, leading edge technology with expert management and an extensive range of support services.

Not forgetting, of course, the traditional Irish welcome!



The Convention Centre Dublin on the River Liffey



## DELIVERING THE SERVICE YOU EXPECT FROM A WORLD-CLASS VENUE

Underlining Dublin's global status, The Convention Centre Dublin will welcome both Irish and international visitors including high-profile VIP's, business leaders, scholars, academics and professionals from all walks of life.

Whatever the event, from a large international convention for eight thousand to a board meeting for eight, or a prestigious banquet attended by heads of state to a major product launch beamed around the world, The Convention Centre Dublin is committed to delivering premium levels of customer service for all.

Our team, with extensive experience gained with the award-winning International Convention Centre, Birmingham (part of The NEC Group), will ensure that your experience of this world-class venue is second to none – The Convention Centre Dublin is a unique centre of excellence.

This landmark building of international importance was designed by Pritzker Award-winning architect Kevin Roche, and features a stunning glass-fronted atrium running the full height of the building – giving visitors panoramic views of the River Liffey, Dublin city centre and the Wicklow mountains.

Recognised as the world's first carbon neutral convention centre, The CCD was designed to meet the highest standards of environmental sustainability. The building was constructed using low carbon Ecocem concrete and we are focused on long-term operational management, particularly in the areas of energy usage and waste management.

# INSPIRATION ON MANY LEVELS

The Convention Centre Dublin offers extremely flexible and multi-purpose meeting spaces, which can be tailored to your individual requirements.

This technically sophisticated venue is designed to the very latest standards. All the halls and meeting rooms are Wi-Fi enabled and have the most advanced audio-visual equipment and lighting systems.

What's more, at The CCD we offer a level of service that is second to none. From our professional Sales Team to our meticulous Event Managers, our Technical Production experts to our friendly CCD Hosts, our mission is to make your event a successful and memorable one for you, your clients, delegates and guests.

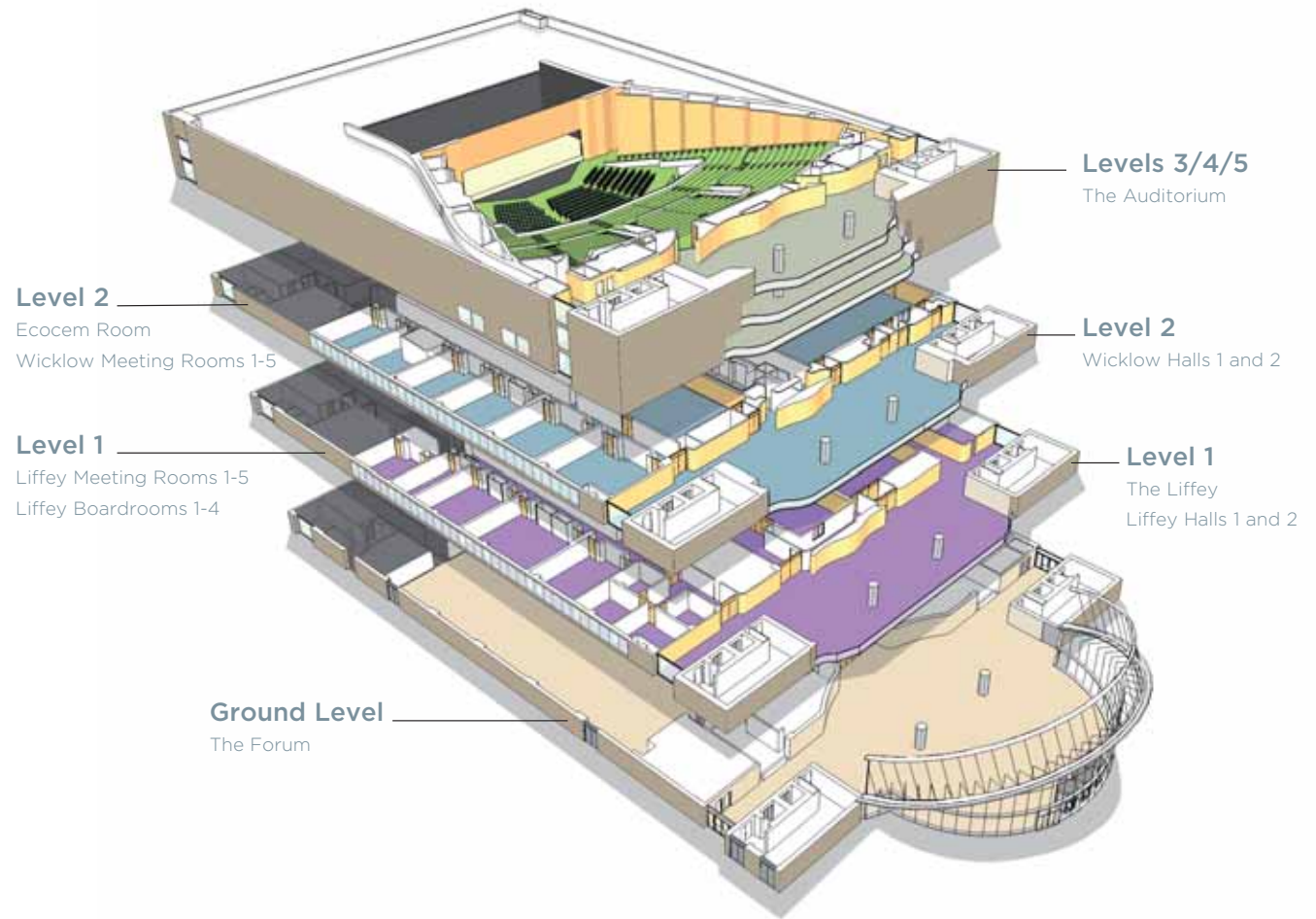

## THE CONVENTION CENTRE DUBLIN FLOOR PLAN



**Boardroom**



**The Auditorium**



**Banqueting**



**Control Room**



**Meeting Room**

# DEDICATED TO BRINGING YOUR EVENT TO LIFE

When you book an event at The CCD you are promised a lot more than an inspirational space! Your dedicated Event Manager and Technical Production Manager will work with you to plan and deliver your event to make the most of our wonderful venue and cutting-edge technology, ensuring a world-class experience for all your guests.

We offer comprehensive packages that include a range of premium services: CCD Events; CCD Technical; CCD Hosts and CCD Cleaning. You may also wish to choose from our growing range of additional services, including fine dining and large scale banqueting from CCD Hospitality, as well as security, production and staging.

Ireland is the land of a thousand welcomes and, at The CCD, we live this ethos. Our CCD Hosts will welcome you and your guests, guiding them to their event and answering all of their questions about the venue and Dublin. We promise you and your guests a memorable event, delivered with warmth and passion by our experienced and highly trained team.

“IN DUBLIN’S FAIR CITY, WHERE THE GIRLS ARE SO PRETTY, I FIRST LAID MY EYES ON S  
AS SHE WHEELED HER WHEELBARROW, THROUGH STREETS BROAD AND NARROW, CR  
ALIVE, ALIVE-O.”

(‘MOLLY MALONE’ TRADITIONAL DUBLIN SONG)

## IN DUBLIN’S FAIR CITY...

Welcome to the city where 21st century technology meets a thousand years of history, where traditional singing pubs live side-by-side with sushi bars and where Dublin wit mingles with the sound of many languages on its streets.

Dublin is also a city that never forgets how to relax, socialise and enjoy the ‘craic’. The ‘craic’ is the Irish expression for having a good time, with the emphasis on laughter, chat, fun and song. Wherever you go in Dublin, whether it’s a pub, club or restaurant, you’ll find yourself in its midst.

### **THE CHANGING FACE OF DUBLIN**

Spencer Dock on the north side of the River Liffey is Dublin’s most exciting docklands development of recent years.

Undergoing a major regeneration, this area adjoins the International Financial Services Centre, a hive of activity by day and night with business, retail and leisure facilities - all situated beside the magnificent waterfront.

You will find the city’s major attractions, restaurants, leading department stores, boutiques, shops and top class hotels all within walking distance.

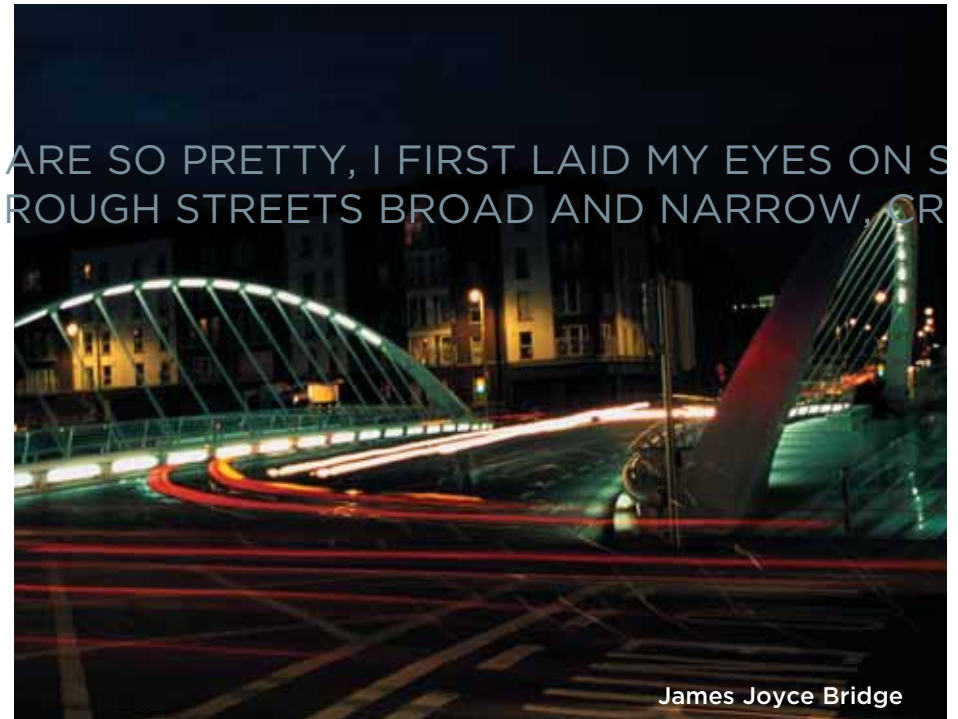

James Joyce Bridge



Trinity College

SWEET MOLLY MALONE.  
EATING COCKLES AND MUSSELS,



Custom House



Enjoying the Craic

## THROUGH STREETS BROAD AND NARROW...

Historic buildings can be found on every street, so keep your eyes open for Dublin Castle, St. Patrick's Cathedral, National Gallery, Trinity College, Christchurch Cathedral, the General Post Office, Government Buildings, the National Museum and many more. And there's one place no visitor should miss - the Guinness Storehouse, home of the traditional pint of Guinness.

There's plenty to charm the culture-lover. Art galleries, museums and architectural gems surround you, giving a glimpse of Dublin's colourful heritage. This is a city full of literary landmarks, thanks to writers such as Swift, Shaw, Yeats, Joyce and Beckett.

Trinity College, one of the oldest universities in these islands, is amongst the most prominent landmarks in the city centre. The famous Book of Kells, one of the oldest Irish hand-illustrated manuscripts (around 800 AD), is on display in the Old Library of Trinity College.

Ireland is also a passionate sporting nation. Traditional Gaelic games such as football and hurling flourish in every county. The spiritual home of the Gaelic Athletic Association (GAA) is the legendary Croke Park stadium on the north side of the city. Rugby has always been a passion for the Irish, and its traditional home, Lansdowne Road, has recently been re-built as the stunning Aviva Stadium.

Try your luck at one of Dublin's racecourses such as The Curragh, Leopardstown or Punchestown, and you might come back a winner. Whatever your handicap, you'll enjoy playing a few holes on the superb golf courses around Dublin, from the nearby links course at Royal Dublin, or Portmarnock to the two championship courses at Powerscourt.

# ALIVE, ALIVE-O!

WHEN EVENING FALLS, THE CITY STREETS COME ALIVE. DUBLIN IS RENOWNED FOR ITS NIGHTLIFE. PUBS, CLUBS, CAFÉS, BARS, RESTAURANTS, THEATRES, COMEDY AND CONCERT VENUES ARE BUZZING EVERY NIGHT OF THE WEEK. THIS IS THE CITY OF OSCAR WILDE AND JAMES JOYCE, OF SEAN O'CASEY AND THE LEGENDARY ABBEY THEATRE. IT'S ALSO THE CITY OF U2, BOYZONE, THE CHIEFTAINS AND RIVERDANCE. DUBLIN HAS SOMETHING FOR EVERYONE, AND EVERYONE IS WELCOME. SPEND AN EVENING DISCOVERING THE TRADITIONAL 'SINGING PUBS' WHERE LOCALS AND VISITORS ALIKE COME TO ENJOY THE MUSIC AND THE 'CRAIC', ACCOMPANIED NO DOUBT BY A CREAMY PINT - OR TWO - OF GUINNESS.

## COCKLES AND MUSSELS

Fine dining has become an art in Dublin, with hundreds of cafés and restaurants spanning every style of cuisine, from the very best of traditional Irish to the finest international and ethnic cooking.

In terms of culinary diversity, value for money and atmosphere, Dublin's restaurants cater for every palate and every budget. Dublin has several Michelin starred restaurants, including the two-starred Patrick Guilbaud, plus one-starred Chapter One, Thornton's and L'Écrivain. Dublin now attracts more and more top chefs, such as Gordon Ramsay who opened his first restaurant in Ireland at The Ritz-Carlton Powerscourt in Dublin.

## DUBLIN CAN BE HEAVEN

*"DUBLIN CAN BE HEAVEN  
WITH A COFFEE AT ELEVEN  
AND A STROLL THROUGH STEPHEN'S GREEN"*  
(*'THE DUBLIN SAUNTER'* POPULAR DUBLIN SONG)

After a busy day of meetings or sightseeing, it's simply bliss to return to your hotel, only a stroll away. Many of the world's leading hotel brands have been attracted to Dublin such as Conrad Hilton, Four Seasons, Marriott, Radisson SAS and Ritz-Carlton. With over 18,000 bedrooms in the City, the breadth of choice ranges from 5-star and boutique hotels to mid-price hotels and friendly bed & breakfasts, many of which are within walking distance of The Convention Centre Dublin.

## FORTY SHADES OF GREEN

Step outside Dublin and you'll discover a whole other country. Ireland is now one of the world's favourite destinations - a land of green fields, tiny villages, castles, mountains, lakes, unspoilt beaches and a relaxed friendly welcome wherever you go.

Take a trip to Wicklow, the 'garden of Ireland' and visit historic Glendalough, site of one of the earliest monastic settlements. Or enjoy a day at the races at Fairyhouse, the venue for Ireland's Grand National.

Further afield, Galway on the west coast is a lively city surrounded by the untamed landscape of Connemara. And to the south, Cork and Kerry offer both spectacular scenery and some of the best restaurants in Ireland.

Venture north and enjoy the scenery of counties Antrim, Down and Derry. The Giant's Causeway, a natural formation of basalt columns, is a major visitor attraction in north Antrim. Did nature create them or are they the footsteps of a Giant? Nobody really knows.



“WHAT’LL YOU HAVE?  
WILL YOU HAVE A PINT?  
I’LL HAVE A PINT WITH  
YOU SIR”

(‘WAXIE’S DARGLE’ TRADITIONAL PUB SONG)



Connemara



Glenveagh Castle, Donegal



Giant's Causeway, Antrim



St. Patrick's Day Parade  
(passing Christchurch Cathedral)



The K Club (home to the Ryder Cup 2006)



Rossbeigh Strand

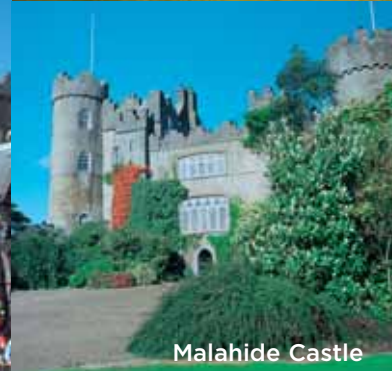

Malahide Castle



# AN INTERNATIONAL GATEWAY THAT WELCOMES THE WORLD

DUBLIN HAS GLOBAL COMMUNICATION LINKS AND IS THE BRIDGE BETWEEN EUROPE AND THE U.S. IT COULDN'T BE EASIER TO GET HERE BY AIR, ROAD, RAIL OR SEA.

Dublin Airport is Ireland's busiest airport, with over 75 airlines flying to over 200 destinations, including direct scheduled daily flights from North America, mainland Europe, Britain and regular flights from the Emirates. It is currently undergoing a €2 billion investment programme, to include a new passenger terminal by the end of 2010, which will increase annual passenger capacity to over 35 million.

The airport is conveniently located 10km north of Dublin city centre, with excellent road links to The Convention Centre Dublin, only 20 minutes away via Dublin Port Tunnel, which brings visitors directly into Spencer Dock.

The Convention Centre Dublin is located in the heart of the city, with easy road access and extensive public transport links including buses and trams. Spencer Dock has a new rail station which links directly to Heuston and Connolly stations, the centres for rail travel to the rest of Ireland.

Frequent ferry services operate to Dublin from various points in Britain and Europe, with Dublin Port Ferry Terminal only five minutes from The Convention Centre Dublin by direct road link, to facilitate the swift delivery of goods.

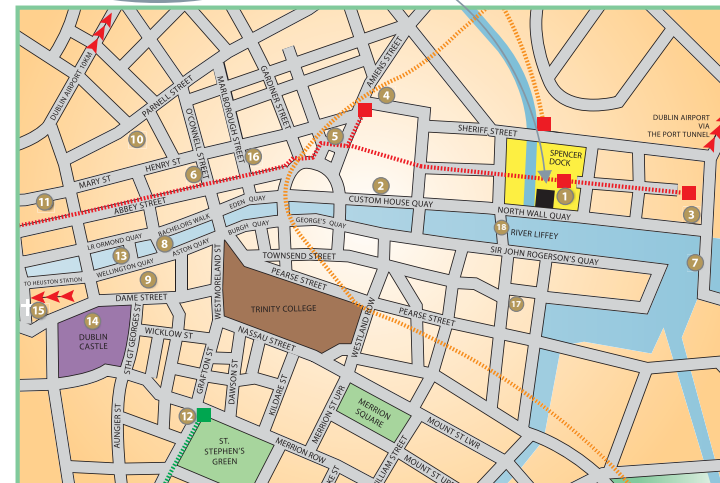
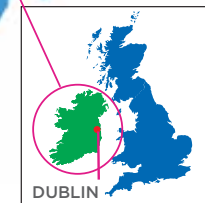

- 1 Spencer Dock Station
- 2 Custom House
- 3 Point Theatre
- 4 Connolly Station
- 5 Busaras
- 6 GPO General Post Office
- 7 East Link Bridge
- 8 Ha'penny Bridge
- 9 Temple Bar
- 10 ILAC Centre
- 11 Jervis Centre
- 12 St. Stephen's Green Centre
- 13 Milenium Bridge
- 14 Dublin Castle
- 15 Christchurch Cathedral
- 16 Abbey Theatre
- 17 Grand Canal Theatre
- 18 Samuel Beckett Bridge

## DUBLIN CITY CENTRE

# THAT'S ABOUT THE SIZE OF IT

AREA	LEVEL	BOARDROOM CAPACITY	THEATRE CAPACITY	BANQUETING CAPACITY**	M <sup>2</sup>	MINIMUM HEIGHT	MAXIMUM HEIGHT	AV CONTROL ROOMS	DIVISIBLE
The Forum	Ground		3040	2000	2721	7m	8m	1	No
The Liffey	1		1806	1220	1650	7m	8m	1	Yes
The Liffey A	1		710	470	626	7m	8m	1	No
The Liffey B	1		954	610	897	7m	8m	0	No
The Auditorium*	3, 4, 5		2000					1	No
Liffey Hall 1	1	68	244	150	174	3.2m	4.3m	1	No
Liffey Hall 2	1	74	309	190	224	3.2m	4.3m	1	No
Wicklow Hall 1	2	70	244	160	187	3.2m	4.3m	1	No
Wicklow Hall 2	2	120	506	350	425	3.2m	4.3m	2	Yes
Wicklow Hall 2a	2	76	268	200	222	3.2m	4.3m	1	No
Wicklow Hall 2b	2	70	238	150	201	3.2m	4.3m	1	No
Liffey Meeting Room 1	1	34	78	50	69	3.25m	3.25m	0	No
Liffey Meeting Room 2	1	48	143	80	107	3.25m	3.25m	0	Yes
Liffey Meeting Room 2a	1	34	77	50	66	3.25m	3.25m	0	No
Liffey Meeting Room 2b	1	28	48	30	39	3.25m	3.25m	0	No
Liffey Meeting Room 3	1	38	101	60	79	3.25m	3.25m	0	Yes
Liffey Meeting Room 3a	1	28	48	30	39	3.25m	3.25m	0	No
Liffey Meeting Room 3b	1	22	40	30	39	3.25m	3.25m	0	No
Liffey Meeting Room 4	1	28	49	30	41	3.25m	3.25m	0	No
Liffey Meeting Room 5	1	28	70	40	51	3.25m	3.25m	0	No
Ecocem Room	2	40	112	70	99	3.25m	3.25m	0	No
Wicklow Meeting Room 1	2	40	96	70	84	3.25m	3.25m	0	No
Wicklow Meeting Room 2	2	40	104	60	79	3.25m	3.25m	0	Yes
Wicklow Meeting Room 2a 2		22	40	30	39	3.25m	3.25m	0	No
Wicklow Meeting Room 2b 2		22	40	20	39	3.25m	3.25m	0	No
Wicklow Meeting Room 3	2	34	78	50	71	3.25m	3.25m	0	No
Wicklow Meeting Room 4	2	34	70	50	65	3.25m	3.25m	0	No
Wicklow Meeting Room 5	2	34	78	50	71	3.25m	3.25m	0	No
Liffey Boardroom 1	1	8			21	3.25m	3.25m	0	No
Liffey Boardroom 2	1	10			31	3.25m	3.25m	0	No
Liffey Boardroom 3	1	8			32	3.25m	3.25m	0	No
Liffey Boardroom 4	1	6			18	3.25m	3.25m	0	No

• All rooms are Wi-Fi enabled

\* 7 Simultaneous Interpretation Booths

\*\* Banqueting numbers are based on oval tables of ten without a stage

YOU SEE THINGS; AND YOU SAY, "WHY?"  
BUT I DREAM THINGS THAT NEVER WERE;  
AND I SAY "WHY NOT?" George Bernard Shaw 1921



The Convention Centre Dublin  
Spencer Dock  
North Wall Quay  
Dublin 1

t +353 1 856 0000  
e [marketing@theccd.ie](mailto:marketing@theccd.ie)  
w [www.theccd.ie](http://www.theccd.ie)

---

This printed item is produced on paper from sustainable forests.  
This information is correct at the time of going to print. It may be altered at any time without liability on the part of Spencer Dock Convention Centre Limited.  
Published by Spencer Dock Convention Centre Limited. June 2010.